

State of South Carolina  
 Pursuant to a warrant from John Thomas Esq. Co. N. of Saluda River I have admeasured & laid out unto William Wilkins a tract of two hundred acres of land. Situate in Pinckney District Union County, on the Branches of this river. Bounded S. by Innans land W. by Adam Gowditchs N. by William Moorheads E. by Matthews Robertsons lands by John M. Whators, and hath such shape & marks as the above Plat Represents  
 Surveyd this 7<sup>th</sup> June 1792

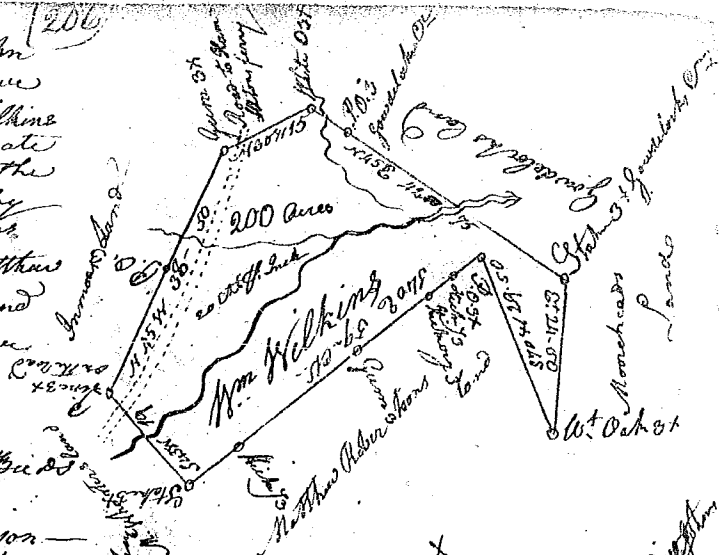

Recorded the 13<sup>th</sup> July 1792  
 S. Carolina Pursuant to a warrant from John Thomas Esq. Co. N. of Saluda River I have admeasured & laid out unto William Wilkins a tract of One hundred & Ninety six acres of land. Situate in Pinckney District Union County on the Branches of this river. Bounded on the S. by Sam. Little Johns land by Charles Little John N. by land laid out to one Johnson and by vacant land, & hath such shape & marks as the above Plat Represents  
 Surveyd the 8<sup>th</sup> June 1792

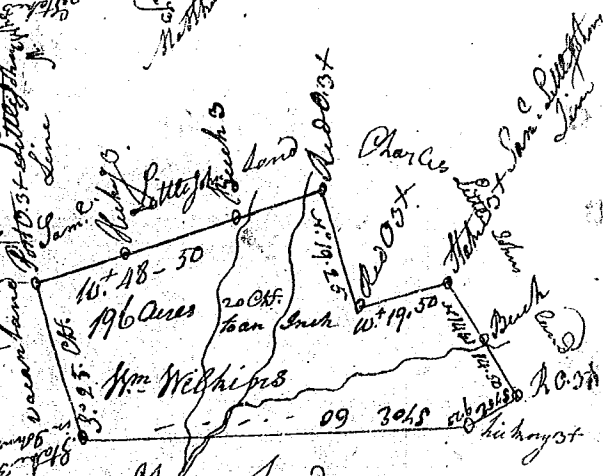

Recorded the 13<sup>th</sup> July 1792  
 by Vardry M. Blair Esq. Johnsons Land  
 to the son of the Owner

South Carolina Pursuant to a warrant from John Thomas Esq. Co. N. of Saluda River I have admeasured and laid out unto Eli M. Bay a tract of Two hundred and sixty acres of land, in Ninety District in Spartanburg County on both sides of Meadowfork the waters of Lawsons fork of Pacolet river, bounded on all sides on Vacant Land and hath such shape form & marks as the above Plat Represents.

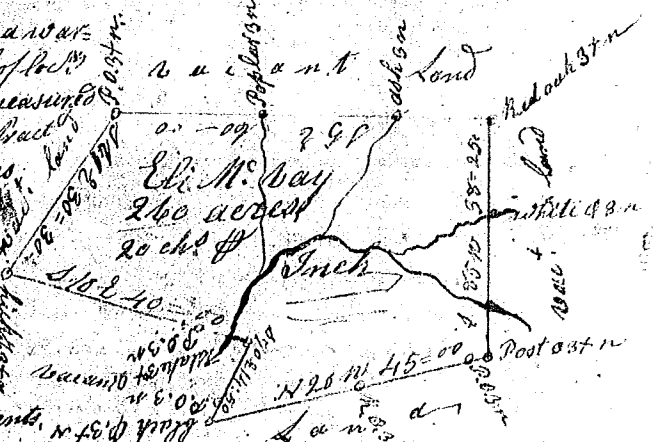

Recorded 17<sup>th</sup> July 1792. Surveyd 17<sup>th</sup> Dec. 1791. John Young Esq. S. C.

S. Carolina Pursuant to a warrant from John Thomas Esq. Co. N. of Saluda River I have admeasured and laid out unto Eli M. Bay a tract of Two hundred and sixty acres of land, in Ninety District in Spartanburg County on both sides of Meadowfork the waters of Lawsons fork of Pacolet river, bounded on all sides on Vacant Land and hath such shape form & marks as the above Plat Represents.

Recorded 13<sup>th</sup> July 1792  
 Surveyd the 26<sup>th</sup> Oct. 1791